

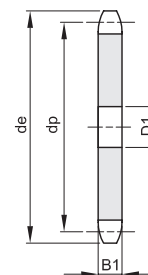

# CORONE PER CATENE TRASPORTO

## PLATE WHEELS FOR CONVEYOR CHAINS

### PASSO 50 RULLO 25

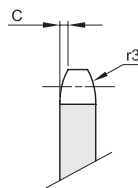

B1	C	r3
10,5	3	50

Materiale: Fe

Z	de	dp	D1	Kg.	Z	de	dp	D1	Kg.
6	121,0	100,00	20	0,55	21	356,5	335,45	30	7,39
7	136,0	115,24	20	0,76	22	372,5	351,35	30	7,88
8	151,5	130,65	20	0,92	23	388,0	367,20	30	8,15
9	167,0	146,20	20	1,15	24	404,0	383,05	30	8,68
10	183,0	161,80	25	1,52	25	420,0	398,95	30	9,66
11	198,5	177,50	25	1,86	28	467,5	446,55	30	13,15
12	214,0	193,20	25	2,20	30	499,5	478,35	30	14,82
13	230,0	208,95	25	2,56	35	579,0	557,80	30	19,10
14	245,5	224,70	25	2,99	38	626,5	605,45	30	21,50
15	261,5	240,45	25	3,40					
16	277,5	256,30	30	3,94					
17	293,0	272,11	30	4,73					
18	309,0	287,95	30	4,94					
19	325,0	303,80	30	6,00					
20	340,5	319,60	30	6,10					

### PASSO 50 RULLO 31

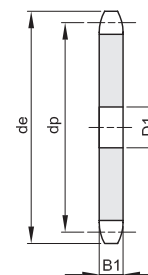
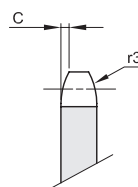

B1	C	r3
13,5	3	50

Materiale: Fe

Z	de	dp	D1	Kg.	Z	de	dp	D1	Kg.
6	120,0	100,00	20	0,61	21	355,5	335,45	30	8,65
7	135,0	115,24	20	0,86	22	371,5	351,35	30	9,44
8	150,5	130,65	20	1,16	23	387,0	367,20	30	10,28
9	166,0	146,20	20	1,48	24	403,0	383,05	30	11,25
10	182,0	161,80	25	1,83	25	419,0	398,95	30	12,30
11	197,5	177,50	25	2,27	26	435,0	414,80	30	13,34
12	213,0	193,20	25	2,72	28	466,5	446,55	30	15,52
13	229,0	208,95	25	3,21	30	498,5	478,35	30	17,95
14	244,5	224,70	25	3,71	32	530,0	510,10	30	20,46
15	260,5	240,45	25	4,33	38	625,5	605,45	30	26,60
16	276,5	256,30	30	4,94					
17	292,0	272,11	30	5,58					
18	308,0	287,95	30	6,30					
19	324,0	303,80	30	7,04					
20	339,5	319,60	30	7,82					



# CORONE PER CATENE TRASPORTO

## PLATE WHEELS FOR CONVEYOR CHAINS

### PASSO 50,8 RULLO 30

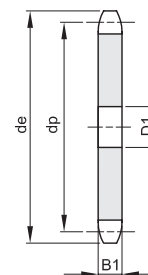
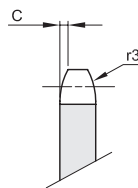

B1	C	r3
8,8	3	50

Materiale: Acciaio C 43

Z	de	dp	D1	Kg.
8	149,0	132,74	20	0,67
10	182,0	164,39	25	1,22
12	214,0	196,27	25	1,81
14	247,0	228,29	25	2,49
16	279,0	260,39	30	3,24

Z	de	dp	D1	Kg.

### PASSO 75 RULLO 25

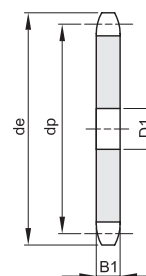
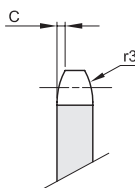

B1	C	r3
10,5	3	50

Materiale: Fe

Z	de	dp	D1	Kg.
8	211,0	195,98	25	2,47
10	258,0	242,70	25	3,77

Z	de	dp	D1	Kg.

### PASSO 75 RULLO 31

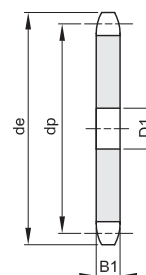
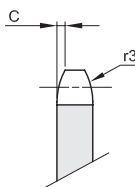

B1	C	r3
13,5	3	50

Materiale: Fe

Z	de	dp	D1	Kg.
6	168,0	150,00	25	1,68
8	215,0	195,98	25	2,94
9	238,0	219,30	25	3,78
10	261,0	242,70	30	4,50
11	286,0	266,25	30	5,57
12	309,0	289,80	30	6,70

Z	de	dp	D1	Kg.
13	333,0	313,42	30	7,80
14	357,0	337,05	30	9,12
15	380,0	360,73	30	10,42
16	404,0	384,45	30	11,98
20	499,0	479,40	30	18,35
21	523,0	503,17	30	20,62



## CORONE PER CATENE TRASPORTO PLATE WHEELS FOR CONVEYOR CHAINS

**PASSO 100  
RULLO 31**

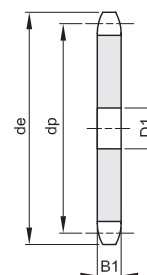
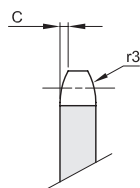

B1	C	r3
13,5	3	50

Materiale: Fe

Z	de	dp	D1	Kg.
6	218,0	200,00	25	3,32
7	249,0	230,48	25	4,32
8	280,0	261,31	30	5,50
9	311,0	292,40	30	6,95
10	342,0	323,61	30	8,57
11	375,0	354,95	30	10,29
12	406,0	386,40	30	12,45
13	437,0	417,90	30	14,45
14	469,0	449,40	30	16,84
15	500,0	480,97	30	19,36
16	532,0	512,60	30	21,76

Z	de	dp	D1	Kg.

**PASSO 100  
RULLO 40**

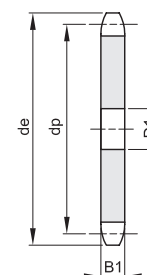
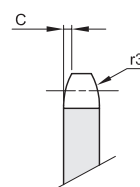

B1	C	r3
20	3	50

Materiale: Fe

Z	de	dp	D1	Kg.
6	220,0	200,00	25	4,54
7	251,0	230,48	25	6,10
8	283,0	261,31	30	7,87
9	314,0	292,40	30	9,94
10	345,0	323,61	30	12,25
11	378,0	354,95	30	14,72
12	409,0	386,40	30	17,48
13	441,0	417,90	30	20,90

Z	de	dp	D1	Kg.



# PIGNONI PER CATENE TRASPORTO SPROCKETS FOR CONVEYOR CHAINS

## PASSO 50 RULLO 25

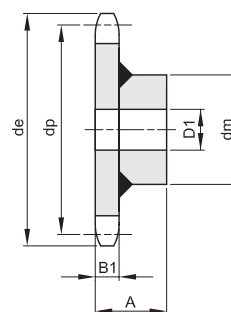
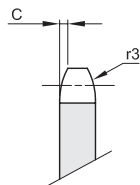

B1	C	r3
----	---	----

10,5	3	50
------	---	----

Materiale: Fe

Z	de	dp	dm	D1	A	Kg.
6	121,0	100,00	58	20	40,5	1,11
7	136,0	115,24	58	20	40,5	1,37
8	151,5	130,65	58	20	40,5	1,55
9	167,0	146,20	58	20	40,5	1,89
10	183,0	161,80	88	25	45,5	3,10
11	198,5	177,50	88	25	45,5	3,44
12	214,0	193,20	88	25	45,5	3,79
13	230,0	208,95	88	25	45,5	4,17
14	245,5	224,70	88	25	45,5	4,63
15	261,5	240,45	88	25	45,5	5,09
16	277,5	256,30	118	30	60,5	8,26
17	293,0	272,11	118	30	60,5	9,10
18	309,0	287,95	118	30	60,5	9,26
19	325,0	303,80	118	30	60,5	10,32
20	340,5	319,60	118	30	60,5	10,42

Z	de	dp	dm	D1	A	Kg.
21	356,5	335,45	118	30	60,5	11,71
22	372,5	351,35	118	30	60,5	12,20
23	388,0	367,20	118	30	60,5	12,47
24	404,0	383,05	118	30	60,5	13,00
25	420,0	398,95	118	30	60,5	13,98
28	467,5	446,55	133	30	62	18,62
30	499,5	478,35	133	30	62	20,29
35	579,0	557,80	133	30	62	24,57
38	626,5	605,45	133	30	62	26,97

## PASSO 50 RULLO 31

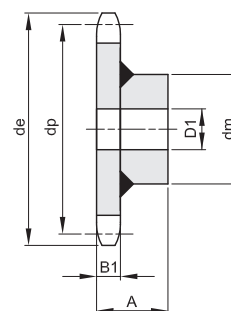
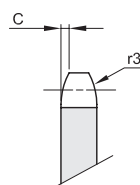

B1	C	r3
----	---	----

13,5	3	50
------	---	----

Materiale: Fe

Z	de	dp	dm	D1	A	Kg.
6	120,0	100,00	58	20	43,5	1,18
7	135,0	115,24	58	20	43,5	1,44
8	150,5	130,65	58	20	43,5	1,72
9	166,0	146,20	58	20	43,5	2,05
10	182,0	161,80	88	25	48,5	3,40
11	197,5	177,50	88	25	48,5	3,80
12	213,0	193,20	88	25	48,5	4,30
13	229,0	208,95	88	25	48,5	4,78
14	244,5	224,70	88	25	48,5	5,37
15	260,5	240,45	88	25	48,5	5,98
16	276,5	256,30	118	30	63,5	9,05
17	292,0	272,11	118	30	63,5	9,60
18	308,0	287,95	118	30	63,5	10,30
19	324,0	303,80	118	30	63,5	11,10
20	339,5	319,60	118	30	63,5	11,90

Z	de	dp	dm	D1	A	Kg.
21	355,5	335,45	118	30	63,5	12,75
22	371,5	351,35	118	30	63,5	13,54
23	387,0	367,20	118	30	63,5	14,38
24	403,0	383,05	118	30	63,5	15,35
25	419,0	398,95	118	30	63,5	16,40
26	435,0	414,80	133	30	65	18,81
28	466,5	446,55	133	30	65	21,00
30	498,5	478,35	133	30	65	23,42
32	530,0	510,10	133	30	65	25,93
38	625,5	605,45	133	30	65	32,10



# PIGNONI PER CATENE TRASPORTO SPROCKETS FOR CONVEYOR CHAINS

## PASSO 50,8 RULLO 30

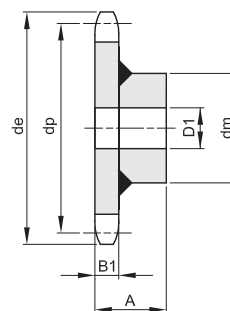
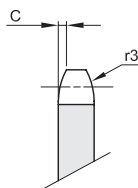

B1	C	r3
8,8	3	50

Materiale: Acciaio C 43

Z	de	dp	dm	D1	A	Kg.
8	149,0	132,74	58	20	39	1,35
10	182,0	164,39	88	25	44	2,85
12	214,0	196,27	88	25	44	3,37
14	247,0	228,29	88	25	44	4,08
16	279,0	260,39	118	30	59	7,34

Z	de	dp	dm	D1	A	Kg.
8	149,0	132,74	58	20	39	1,35
10	182,0	164,39	88	25	44	2,85
12	214,0	196,27	88	25	44	3,37
14	247,0	228,29	88	25	44	4,08
16	279,0	260,39	118	30	59	7,34

## PASSO 75 RULLO 25

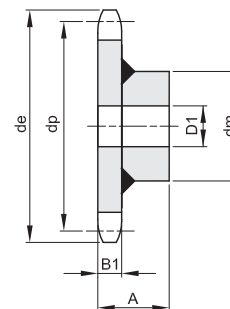
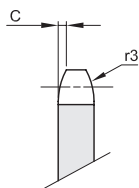

B1	C	r3
10,5	3	50

Materiale: Fe

Z	de	dp	dm	D1	A	Kg.
8	211,0	195,98	88	25	45,5	4,07
10	258,0	242,70	118	25	60,5	7,87

Z	de	dp	dm	D1	A	Kg.
8	211,0	195,98	88	25	45,5	4,07
10	258,0	242,70	118	25	60,5	7,87

## PASSO 75 RULLO 31

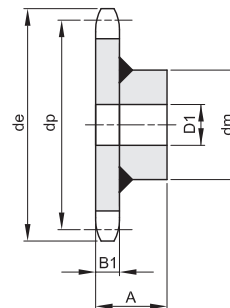
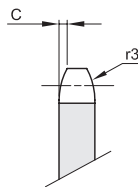

B1	C	r3
13,5	3	50

Materiale: Fe

Z	de	dp	dm	D1	A	Kg.
6	168,0	150,00	88	25	48,5	3,26
8	215,0	195,98	88	25	48,5	4,52
9	238,0	219,30	88	25	48,5	5,36
10	261,0	242,70	118	30	63,5	8,70
11	286,0	266,25	118	30	63,5	9,60
12	309,0	289,80	118	30	63,5	10,73

Z	de	dp	dm	D1	A	Kg.
13	333,0	313,42	118	30	63,5	11,83
14	357,0	337,05	118	30	63,5	13,15
15	380,0	360,73	118	30	63,5	14,45
16	404,0	384,45	133	30	65	17,43
20	499,0	479,40	133	30	65	23,80
21	523,0	503,17	133	30	65	26,07

