

# TALKOB®

## New – Safety couplings



**SAFE-LOCK™ Safety couplers are made in accordance to the safety demands of the EU safety Directive 97/23/EF enclosure 1.**

### **SAFE-LOCK™ Safety couplers**

- Eliminates risk of fatal injuries.
- Cannot be disconnected when pressurized
- Available in Euro Program and International Program
- 100 % compatible with existing connectors.
- Resistant to Oil and Water up to 200 °C

Usually mould cooling systems operates with working temperatures between 90 – 170 °C degrees, and many systems operates with non valved couplers, which increase risks of fatal injuries for the operator.

### **Maximum Flow – Maximum Safety**

Only double sided shut off valves in both coupler and nipple will eliminate the need for Safe-Lock™ Safety couplers – but the valves will reduce the flow capacity - Safe-Lock™ will not!

### **How does it work?**

The Safe-Lock™ couplers eliminates this risk – due to the special locking mechanism which locks the coupling sleeve when the coupler is pressurized, and the couplers cannot be disconnected from the nipple. (see image figure A and B)

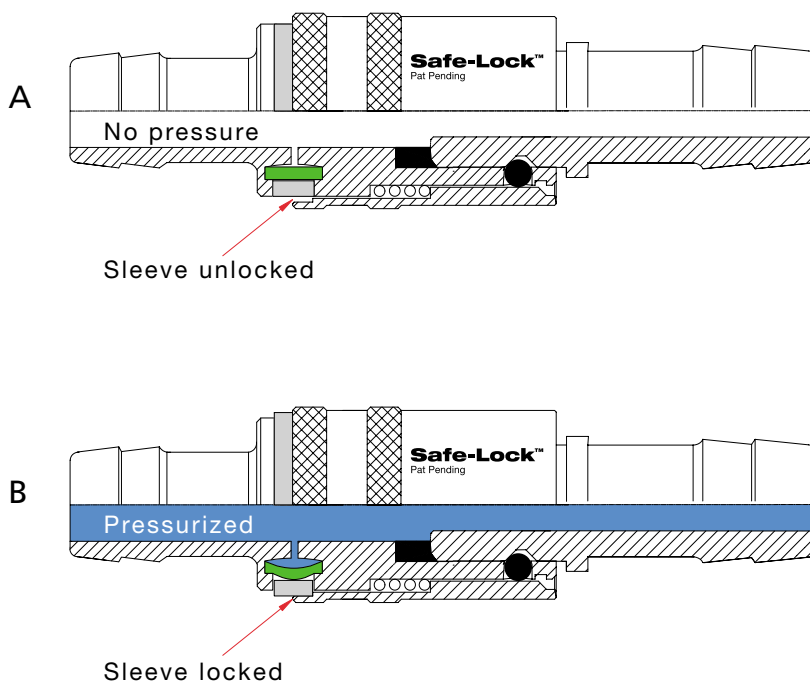

SAFE-LOCK™ Pat Pending and registered model.



**TL..**

| S | Series | No.       | No.         | D  | L  | d  | K  |
|---|--------|-----------|-------------|----|----|----|----|
| 6 | 65     | TL6510-SL | TL6510OV-SL | 17 | 49 | 10 | 9  |
|   |        | TL9013-SL | TL9013OV-SL |    |    |    |    |
| 9 | 90     |           |             | 23 | 56 | 13 | 13 |

| S | Series | No.       | No.         | D  | L  | d  | K  |
|---|--------|-----------|-------------|----|----|----|----|
| 6 | 70     | TL7006-SL | TL7006OV-SL | 18 | 51 | 6  | 9  |
|   |        | TL7010-SL | TL7010OV-SL |    |    | 10 |    |
| 9 | 95     | TL9510-SL | TL9510OV-SL | 23 | 62 | 13 | 13 |
|   |        | TL9513-SL | TL9513OV-SL |    |    |    |    |

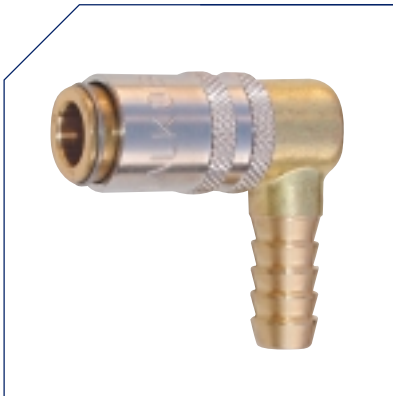
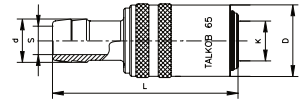

**TV../90**

| S | Series | No.          | No.            | D  | L  | d  | K  |
|---|--------|--------------|----------------|----|----|----|----|
| 6 | 65     | TV6510/90-SL | TV6510/90OV-SL | 17 | 48 | 10 | 9  |
|   |        | TV9013/90-SL | TV9013/90OV-SL |    |    |    |    |
| 9 | 90     |              |                | 23 | 53 | 13 | 13 |

| S | Series | No.          | No.            | D  | L  | d  | K  |
|---|--------|--------------|----------------|----|----|----|----|
| 6 | 70     | TV7006/90-SL | TV7006/90OV-SL | 18 | 50 | 6  | 9  |
|   |        | TV7010/90-SL | TV7010/90OV-SL |    |    | 10 |    |
| 9 | 95     | TV9510/90-SL | TV9510/90OV-SL | 23 | 62 | 13 | 13 |
|   |        | TV9513/90-SL | TV9513/90OV-S  |    |    |    |    |

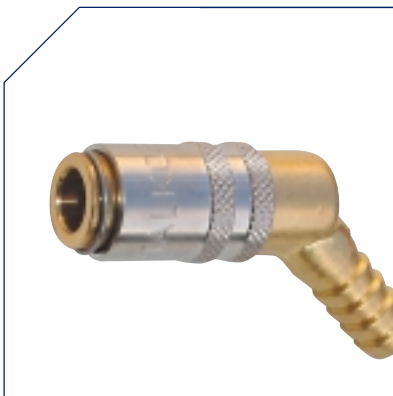
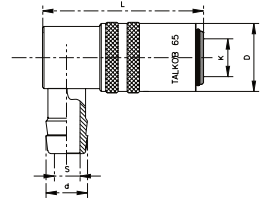

**TV../45**

| S | Series | No.          | No.            | D  | L  | d  | K  |
|---|--------|--------------|----------------|----|----|----|----|
| 6 | 65     | TV6510/45-SL | TV6510/45OV-SL | 17 | 48 | 10 | 9  |
|   |        | TV9013/45-SL | TV9013/45OV-SL |    |    |    |    |
| 9 | 90     |              |                | 23 | 56 | 13 | 13 |

| S | Series | No.          | No.            | D  | L  | d  | K  |
|---|--------|--------------|----------------|----|----|----|----|
| 6 | 70     | TV7006/45-SL | TV7006/45OV-SL | 18 | 50 | 6  | 9  |
|   |        | TV7010/45-SL | TV7010/45OV-SL |    |    | 10 |    |
| 9 | 95     | TV9510/45-SL | TV9510/45OV-SL | 23 | 62 | 13 | 13 |
|   |        | TV9513/45-SL | TV9513/45OV-SL |    |    |    |    |

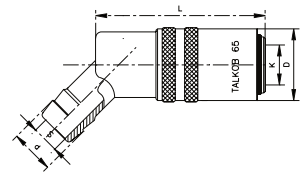

**TU..**

| S | Series | No.        | No.          | D  | L  | A         | K  | A/F |
|---|--------|------------|--------------|----|----|-----------|----|-----|
| 6 | 65     | TU65M10-SL | TU65M10OV-SL | 17 | 48 | M10X1     | 9  | 17  |
|   |        | TU65M14-SL | TU65M14OV-SL |    |    | M14X1,5   |    |     |
|   |        | TU651/4-SL | TU651/4OV-SL |    |    | 1/4" BSPT |    |     |
|   |        | TU653/8-SL | TU653/8OV-SL |    |    | 3/8" BSPT |    |     |
| 9 | 90     | TU901/4-SL | TU901/4OV-SL | 23 | 53 | 1/4" BSPT | 13 | 21  |
|   |        | TU903/8-SL | TU903/8OV-SL |    |    | 3/8" BSPT |    |     |
|   |        | TU901/2-SL | TU901/2OV-SL |    |    | 1/2" BSPT |    |     |

| S | Series | No.        | No.          | D  | L  | A         | K  | A/F |
|---|--------|------------|--------------|----|----|-----------|----|-----|
| 6 | 70     | TU701/4-SL | TU701/4OV-SL | 18 | 50 | 1/4" BSPT | 9  | 17  |
|   |        | TU703/8-SL | TU703/8OV-SL |    |    | 3/8" BSPT |    |     |
| 9 | 95     | TU951/4-SL | TU951/4OV-SL | 23 | 62 | 1/4" BSPT | 13 | 21  |
|   |        | TU953/8-SL | TU953/8OV-SL |    |    | 3/8" BSPT |    |     |
|   |        | TU951/2-SL | TU951/2OV-SL |    |    | 1/2" BSPT |    |     |

